



# **Oregon State Beekeepers Association**

## **2023 Fall Conference**

### **October 27–29, 2023**

**Riverhouse Convention Center | Bend, Oregon & Online**

## **Conference Program**

## 2023 OSBA Executive Committee



### OSBA OFFICERS

#### President

Joe Maresh—503.703.5060; joemaresh@bctonline.com

#### Vice President

Jeremy Mitchell—503.399.8409; osba.vice.president@gmail.com

#### Secretary

Barbara Derkacht—503.631.3063; bderkacht@yahoo.com

#### Treasurer

Becca Fain—541.997.3792; rfain18@gmail.com

#### Past President

John Jacob—541.582.2337; oldsolbees@gmail.com

### OSBA REGIONAL REPRESENTATIVES

#### North Coast

Rick Olson—541.991.7946; mowgli667@yahoo.com

#### South Coast

Mureen Walker—541.373.7997; mureen98@gmail.com

#### Columbia Basin

Bill Edwards—541.354.2223; bfamily@live.com

#### Eastern Oregon

Jordan Dimock—541.372.2726; beelady60tamera@aol.com

#### Portland Metro

Tom Cinquini—503.547.5386; tomcinquini@gmail.com

#### South Central Oregon

Christy VanRooyen—541.885.0959; vanrooyen.christy@gmail.com

#### Southwestern Oregon

Andrew Watson—boradabeedoc@gmail.com

#### North Willamette Valley

Nathan Richard—mnrmrichard@gmail.com

#### South Willamette Valley

Tim Wydronek—541.740.4127; timwydronek@comcast.net

### AFFILIATED REGIONAL ASSOCIATIONS

#### Central Coast Beekeepers Association

Meets 1:30 PM, fourth Wednesday, Newport  
Co-Vice President: Max Kuhn—t.maxkuhn@gmail.com  
Website: www.ccbaor.org

#### Central Oregon Beekeepers Association

Meets 6:00 PM, third Tuesday, Bend  
President: Allen Engle—aengle@bendbroadband.com  
Website: www.cobeekeeping.org

#### Columbia County Oregon Beekeepers

Meets 6:00 PM, first Thursday, St. Helens  
President: Linda Zahl—503.799.7073

#### Columbia Gorge Beekeepers Association

Meets 6:15 PM, third Wednesday, Hood River  
President: Jerry Frazier—jerry1.frazier@gmail.com  
Website: gorgebeekeepers.org

#### Coos Beekeepers Association

Meets 6:00 PM, fourth Thursday, Myrtle Point  
President: Ann Marineau—annmarineau@gmail.com

#### Klamath Basin Beekeepers Association

Meets 9:00 AM, last Saturday, Klamath Falls  
President: Lorena Corzatt—541.892.8402  
Website: www.klamathbeekeepers.org

#### Lane County Beekeepers Association

Meets 6:30 PM, third Tuesday, Eugene  
President: Fonta Molyneaux—wildeverlastingfarm@gmail.com  
Website: www.lcbaor.org

#### Linn Benton Beekeepers Association

Meets 6:30 PM, third Wednesday, Corvallis  
President: Steve Oda—steve@lbba.us  
Website: www.lbba.us

#### Oregon Prison Beekeepers

Program Manager: Chad.E.Naugle@doc.state.or.us

#### Oregon South Coast Beekeepers Association

Meets 6:00 PM, third Thursday, Gold Beach  
President: Maarten Van Otterloo—maartyvo@gmail.com

#### Portland Metro Beekeepers Association

Meets 7:00 PM, second Thursday, Gladstone  
Pres: Paul Stromberg—president@portlandmetrobeekeepers.org  
Website: portlandmetrobeekeepers.org

#### Portland Urban Beekeepers

Meets 7:00 PM, first Wednesday, via Zoom  
President: Brent Hirak—president@portlandurbanbeekeepers.org  
Website: portlandurbanbeekeepers.org

#### Southern Oregon Beekeepers Association

Meets 6:30 PM, first Monday, Central Point  
President: Noah Clipp—noahtitus@gmail.com  
Website: southernoregonbeekeepers.org

#### Tillamook Beekeepers Association

Meets 11:30 AM, second Saturday, Tillamook  
President: Brad York—dbradleyork@gmail.com  
Website: www.tillamookbeekeepers.org

#### Tualatin Valley Beekeepers Association Inc

Meets 6:00 PM, last Tuesday, virtually-North Plains  
President: Debby Garman—tualatinvalleybeekeepers@gmail.com  
Website: tvbabees.org

#### Umpqua Valley Beekeepers Association

Meets 6:00 PM, first Wednesday, Roseburg  
President: Adrian Aramburu—adrockz@msn.com  
Website: www.umpquavalleybeekeepers.org

#### Wallowa County Beekeepers Association

Meets 6:30 PM, last W (F,A,J,A); first W (N), Enterprise  
Co-President: Nelda Murri—509.540.4733

#### Willamette Valley Beekeepers Association

Meets 7:00 PM, fourth Monday, Salem  
President: Richard Farrier—rfarrierfarms@gmail.com  
Website: wvbahive.org

## Welcome & Overview

**Thank You** for joining us for the 2023 Fall Conference of the Oregon State Beekeepers Association, held here in Bend at the Riverhouse Convention Center and online. We are excited to meet and learn as we welcome this year's fine presenters. They bring research findings and updates from a rich background of experience and perspective to add to both our beekeeping practice and our appreciation of the complexities of the life of the honey bee and other pollinators. In addition, they will do all they can to answer our questions!

### PreConference Events

Those arriving early in Bend are able to complete registration as well as attend Friday afternoon's PreConference Beekeeping Basics Workshop or the 2023 Oregon Master Beekeeper Program Institute. These events, along with the October meeting of the OSBA Executive Committee, take place in the Riverhouse Convention Center.

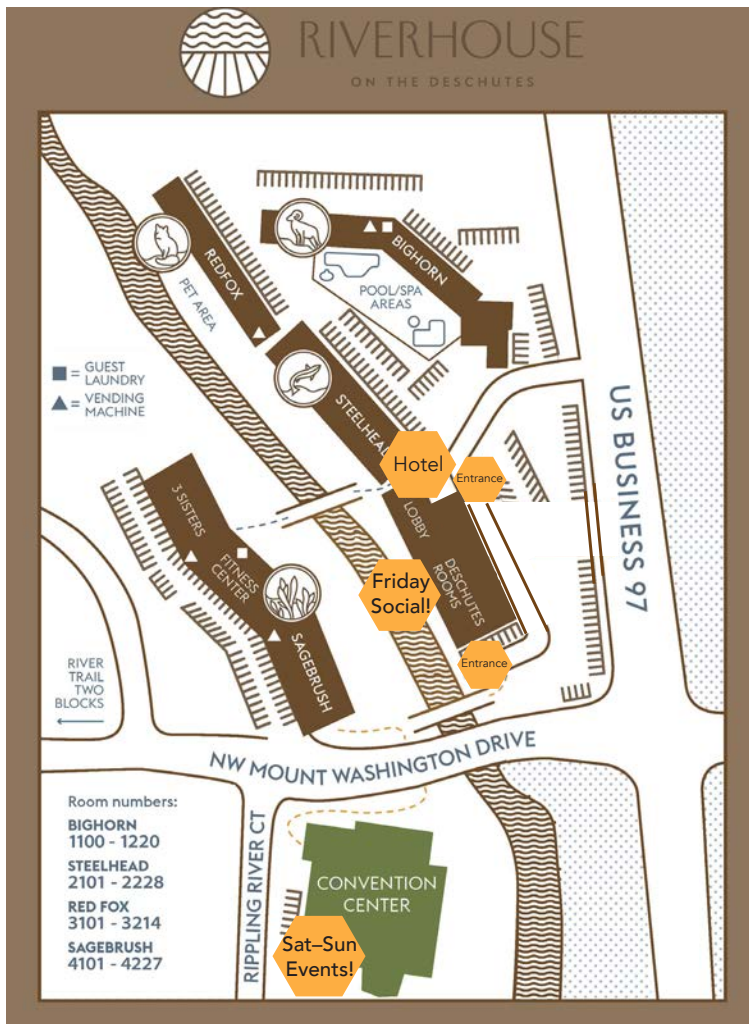

### Friday Evening Social

On Friday evening, we cross NW Mount Washington Drive to gather for the Conference opening in the Deschutes Rooms, North and South, of the Hotel. The traditional Social is made festive with food, drink, and entertainment by John Grant and the Western Revue ([www.cowboyjohngrant.com/](http://www.cowboyjohngrant.com/)). John's music, influenced by numerous well-known country music artists, has engaged audiences throughout the Pacific Northwest since 1981. This is the only event that is held outside the Convention Center.

### Sponsors | Exhibitors | Advertisers

We have opportunities on both Saturday and Sunday to visit with one another as we meet with exhibitors and learn about the goods they've brought to share with us. It's a perfect time as well to thank our sponsors and to review the offerings of our advertisers, as seen throughout the pages of this conference program.

### OSU Honey Bee Lab & Oregon Bee Project

The Oregon Bee Project and the Oregon State University Honey Bee Lab have traveled the distance to share the latest on current projects and research. Be sure to stop by for information and updates.

### Conference Honey Show

Whether or not entering this year's Conference Honey Show (though we hope you do!), we all

can check out this year's entries featuring our best honey, wax, photography—and cookies. Marjie Ehry is Honey Show Judge, and photographs—themed "Find the Humor in Beekeeping"—are a People's Choice Award. Cookie entries are to be shared after judging.

### On-Site Silent and Benefit Auctions & Online Auction

As we donate to and bid on items during our auctions, keep in mind that all proceeds go to research. Both the Silent Auction and the Online Auction end at 7:00 PM on Saturday. The Benefit Auction then takes place following the Conference Banquet. We've been given a preview of an item donated to that auction—watch for the one-of-a-kind Tillamook Cheese Block Hive donated by the Tillamook Beekeepers Association. And through it all, be sure to give this year's auctioneers a hand.





**MANN LAKE<sup>®</sup>**  
**BEE & AG SUPPLY**

***Mann Lake supports  
Oregon State Beekeepers Association!***

**COME VISIT OUR STORE !**

**Woodland, CA**

**800-880-7694**

**OPEN MONDAY - SATURDAY**

**Mann Lake - Oregon Facility**

**2276 Ave H, White City, OR - 97503**

**877-789-7526**

**MANNLAKELTD.COM**

**Be Proactive  
EXPERIENCE THE PROS**



**ProHealth**  
**with Essential Oils**

**ProDFM**  
**Microbial Supplement**

**Pro-Sweet**  
**Liquid Feed**



## General Membership Meeting

Our annual General Membership Meeting takes place on Saturday, October 28, from 5:00 PM to 6:00 PM. We will be reviewing the past year, considering changes to our constitution/bylaws, and holding elections for our 2024 officers and regional representatives. All OSBA members are invited to participate. Let your vote be among those to be counted.

## Raffles!

This year finds us with two generously donated raffle items—a work of encaustic art donated by George Hansen and an Oregon bee license plate (exclusive number 00010) donated by Andony Melathopoulos. Be sure to get your tickets before the drawing, scheduled to take place on Saturday evening just before the Banquet.

## Luncheons and Banquet

Saturday and Sunday Luncheons provide respective opportunities to hear about current activities at Oregon State University from Andony Melathopoulos and Ramesh Sagili. George Hansen and American Honey Queen Selena Rampolla provide updates and guidance on additional programs during the Saturday evening Banquet. Menus for these events are posted at: [orsba.org/2023-evening-social-luncheons-banquet/](https://orsba.org/2023-evening-social-luncheons-banquet/). All require registration with additional cost.

## Conference Recordings

There's much to be gained during the conference. Yet, as many of us have experienced, packed days of conferences can be overwhelming at times. We will have time for review. The recorded conference sessions will be made available to registrants until December 31, 2023.

## Enjoy the Conference!

Note: Please send conference photos to [osba.vice.president@gmail.com](mailto:osba.vice.president@gmail.com) & [osba.newsletter@gmail.com](mailto:osba.newsletter@gmail.com).

## Conference Program Contents & Advertisers

### 2023 Program Contents

OSBA Executive Committee	i
Welcome & Overview	1
Program Contents & Advertisers	3
Conference Sponsors	5
Conference Exhibitors	5
Conference Presenters	7
Session and Event Locations	14
Conference Agenda	15
Program and Abstracts	17
October 27	17
October 28	19
October 29	23
Thank You, Everyone!	26

### Advertisers

Acorn Beekeeping Equipment	12
Almond Board of California	13
Bee Culture Magazine	8
Beeline Apiaries & Woodenware	18
Dadant & Sons Inc	24
Flying Bee Ranch	22
FMI Equipment	12
Foothills Honey Company LLC	24
Heitkams' Honey Bees Inc	22
Hive and Garden	10
Local Hive Honey	4
Mann Lake Ltd	2
Oregon Bee Project	18
Richards Packaging	5
Shonnard's Nursery, Florist & Landscape	3
State Farm Insurance	18
The Beekeeper's Carpenter	16
Walla Walla Valley Honey Company	20
Western Bee Supplies Inc	16
WiFi Hive Scale	16
WSR Insurance Services Inc	6

## Your Success is Our #1 Priority

Bee Nutrition & Medication  
Hive Components  
Tools & Protective Gear  
Consulting & Classes

 *Learn with Us on Youtube!*

**Shonnard's Nursery, Florist, and Landscape**  
6600 SW Philomath Blvd., Corvallis, OR 97333  
541-929-3524 [WWW.SHONNARDS.COM](http://WWW.SHONNARDS.COM)

**Shonnard'S**  
NURSERY • FLORIST • LANDSCAPE



# 100 YEARS of 100% U.S. HONEY

HONEY IS EVERY BEEKEEPER'S LIVELIHOOD, SO WE'RE PROUD TO SUPPORT AMERICAN BEEKEEPERS BY BOTTLING NOTHING BUT 100% U.S. HONEY FROM EVERY PART OF THE COUNTRY. SEND US A SAMPLE, AND WE'LL HELP SHARE YOUR HARD WORK WITH HONEY LOVERS FROM COAST TO COAST.

## FOR MORE INFO, CONTACT:

**NANCY BURNETT**  
M [970] 584-0355  
O [970] 353-6277  
[NANCY@LOCALHIVEHONEY.COM](mailto:NANCY@LOCALHIVEHONEY.COM)

## SEND A SAMPLE TO:

**ATTN: PROCUREMENT DEPT**  
3331 WEST 29TH ST.  
GREELEY, CO 80631



[LOCALHIVEHONEY.COM](http://LOCALHIVEHONEY.COM)



@LOCALHIVEHONEY



## Conference Sponsors



Silver Sponsor



Richards Packaging

Entertainment Sponsor



WSR Insurance Services Inc

Break Sponsor



The Beetanical Apiary

Break Sponsor



Nature's Kick Corporation

## Conference Exhibitors

Apimaye Innovative Beekeeping Equipment

Beeline Apiaries & Woodenware

Dalan Animal Health Inc

Diggin' Livin' Farm & Apiaries

FMI Equipment

Hive IQ

Local Hive Honey

Nectar

Oregon Bee Project

Oregon State University Honey Bee Lab

The Beekeeper's Carpenter

The Beetanical Apiary

True Wood Products

Western Bee Supplies Inc

Wicwas Press

Wraith Scarlett & Randolph Insurance Services Inc

Quality honey  
in quality jars...



Visit locally in Portland or  
give us a call at 503-290-0000

Richards Packaging 9455 NE Alderwood Rd  
KMcGarvey@RichardsPackaging.com





# Apiculture Program Lack of Rainfall Insurance

Now Available in 48 States



We **CUSTOMIZE** a plan of insurance for every customer and every property.

- Decrease premiums
- Increase net indemnities

## RISK MANAGEMENT TOOLS EXCLUSIVE COLONYCALC SOFTWARE:

Only WSR agents have access to ColonyCalc. ColonyCalc shows you;

- Historical payments back to 1948
- What coverage intervals give best protection and net return

## RAINFALL INDEX LOOK UP TOOL

- Accurate interval estimates two days after an interval ends

"After one year of working with WSR on my Lack of Rainfall Insurance, I have a much clearer understanding of the program. One of the things I appreciate most about WSR, is their diligent attention to detail and the time they put in scrutinizing every grid and interval of my policy. My bees never leave the state of Georgia, so I don't have the migratory advantage most beekeepers do when it comes to this program. WSR has written my policy to put me in a position where I am appropriately managing the weather-related risk involved with my business, without adding unnecessary risk with my insurance."

- Patrick Wilbanks, Wilbanks Apiaries, Inc.

"Making a living in an industry that is completely dependent on weather, we knew we needed to find someone to help us manage our risk. Choosing to work with WSR has been one of the finest business decisions Stayer's Quality Queens has made. WSR and their team have streamlined the process of providing Crop Insurance and made it easy to understand. Their knowledge and passion for the beekeeping industry has provided us with financial stability, through this program and industry donations, in an everchanging climate."

- Matt and Sara Stayer, Stayer Quality Queens

FOR MORE INFORMATION OR  
TO OBTAIN A FREE QUOTE  
CONTACT US TODAY!



Stephanie Myers  
(530) 237 - 6282



Cris Armas  
(530) 300 - 3566



Shayne LaFrentz  
(530) 237 - 6281



Andrew Finch  
(850) 333 - 2490



David Westervelt  
(352) 267 - 4646



CA Lic #0B48084

## Conference Presenters

For additional information about this year's presenters, see: [orsba.org/2023-presentations/](https://orsba.org/2023-presentations/).



**Mustafa Bozkus** is a dedicated MS student in the Horticulture Department at Oregon State University, profoundly interested in advancing honey bee health. His current academic pursuit involves specialized research on *Varroa destructor* and European foulbrood diseases, thus reflecting his commitment to enhancing honey bee well-being. Mustafa's studies underscore his dedication to understanding the intricate dynamics of honey bee colonies and his passion for contributing to their sustainable management.



**Carolyn Breece** is senior faculty research assistant for the Oregon State University Honey Bee Lab. She maintains the OSU apiary of 60–80 colonies, provides research support, teaches online beekeeping classes for OSU students, and provides educational workshops and events for Oregon beekeepers. From 2009 to 2016, she coordinated the Oregon Master Beekeeper Program. Carolyn has a BS in biology from University of Oregon and a MS in forestry from Northern Arizona University. Her hobbies include keeping bees, talking about bees, worrying about bees, and dreaming about bees.



**Emily Carlson** joined the Oregon State University Honey Bee Lab in 2019 to pursue a PhD in horticulture; her dissertation focuses on understanding pesticide risk models and where pesticide exposure occurs in a landscape. After graduating from Gonzaga University in 2014, Emily worked in the nonprofit and public sectors as a grant writer and community educator before returning to Oregon for graduate school. She developed a strong interest in science policy and has worked with the Entomological Society of America to advocate for the needs of fellow entomologists and beekeepers. Outside of work, Emily enjoys spending time with her two cats, playing card games, and reading fantasy books.



**Dewey M Caron** is professor emeritus of entomology and wildlife ecology, University of Delaware, and affiliate professor, Department of Horticulture, Oregon State University. Professional appointments have been at Cornell (1968–1970), University of Maryland (1970–1981), and University of Delaware (1981–2009), serving as department chair at the last two. He retired from University of Delaware in 2009 and moved to Portland, Oregon, to be closer to grandkids.



# Bee Culture®

The Magazine of American Beekeeping



- 12 Big Issues a Year
- Digital and Paper Editions
- Catch the Buzz

## ABC and XYZ of Bee Culture - 42nd Edition

- Over 800 pages packed with information
- Hundreds of color photos and illustrations
- More than 50 contributors
- A mix of reference, how and why things are done, and a history of how beekeeping got where it is today



**Get yours today!**

**[Store.BeeCulture.com/books/](http://Store.BeeCulture.com/books/)**

## Subscription Options

### Print Subscriptions

One-year: \$34.00 *only* \$2.83/issue!

Two-year: \$62.00 *only* \$2.58/issue!

### Digital Subscriptions

One-year: \$24.00 *only* \$2/issue!

### Bundle Subscriptions

One-year: \$44.00

*plus more subscription options available!*

**Subscribe Today!**

**[www.BeeCulture.com](http://www.BeeCulture.com)**





**Diana Cox-Foster** is research leader and entomologist at USDA-ARS Pollinating Insects Research Unit (PIRU) in Logan, Utah. PIRU focuses on biology, management, and systematics of all bee species. Diana examines the impact of pathogens and pesticides on bee health for honey bees, bumble bees, and solitary bees. Stakeholders include bee keepers, bee managers, growers who use Apis and non-Apis bees for pollination, and land managers of natural ecosystems. Diana received a BS in entomology and zoology at Colorado State University, MS and PhD in entomology at University of Illinois at Urbana-Champaign, and gained skills in molecular biology as a postdoc at Vanderbilt University. In 1987, she joined Penn State University and, as full professor, transitioned to USDA Agricultural Research Service in October 2015.



**Eileen Garvin** is the author of the national bestselling novel, *The Music of Bees*, and the acclaimed memoir, *How to Be a Sister*. Her new novel, *Crow Talk*, will be published in April 2024. *The Music of Bees* was named a Good Morning America Buzz Pick, a Good Housekeeping Book Club Pick, a *People Magazine* Best New Book, a *Christian Science Monitor* Pick, a Library Reads Pick, a *Washington Post* Best Summer Read, an IndieNext Pick, and more. Eileen's essays have appeared with Medium, *The Oregonian*, *Oregon Humanities Magazine*, PsychologyToday.com, and *Creative Non-Fiction Magazine*. Eileen and her husband share their Hood River home with one fearless calico, a passionate mutt, four chickens, and about 180,000 honey bees.



After a short six-years long career as a public-school teacher, **George Hansen** transformed a hobby beekeeping operation into a commercial endeavor. Starting from a few swarms and retrieved nuisance hives, the Foothills Honey Company LLC now runs 7,000 colonies in three states. Today the focus of the beekeeping is primarily pollination service. Concentrating on a succession of pollinations has required targeted management strategies to keep the hives in good pollinating condition from January to October. As George and his wife Susan transition their business to their sons Matt and Joe, George remains an active member of the beekeeping community as well as serves on a number of boards and steering committees. He and Susan also maintain an "overlarge" garden and spend time in painting studios!



**Amina Harris** is the owner of Z Specialty Food LLC—also known as The HIVE—with her son and daughter. A veritable trailblazer in the field, along with her husband, Ishai Zeldner (z"l), their company Moon Shine Trading was one of the first to pack and promote US varietal honeys winning acclaim and awards from the Specialty Food Association and the National Honey Board. Amina is also the founding director of the Honey and Pollination Center at the Robert Mondavi Institute of Wine and Food Science, UC Davis. During her tenure, the Center produced the internationally known UC Davis Honey Aroma and Flavor Wheel and helped found the California Honey Festival, held annually in Woodland, California. A graduate of the University of Michigan, she holds a MSED in special education from Buffalo State College.



**Joussey Hidrobo Chavez**, an international graduate student from Ecuador, completed her undergraduate degree in agricultural engineering from San Francisco de Quito University and is currently pursuing a MS in horticulture at Oregon State University, where she was awarded a postgraduate education scholarship. Under guidance and supervision from Ramesh Sagili in the Honey Bee Lab and Erica Chernoh of the Berry Initiative Team, Joussey's research has been focused on honey bee pollination in strawberry season production systems using high and low tunnels. Beyond her research, her passion for providing education to Hispanic and Latino communities led to collaboration in translating and recording the Oregon Master Beekeeper Program e-campus material that provided the first master beekeeper program in Spanish in the US.

West Linn, Oregon

Staunton, Virginia



## NEW 3 Hole Vivaldi Board <sup>TM</sup>

## NEW Fortress Bottom Board <sup>TM</sup>



Moisture Management  
Year Round Ventilation  
Insulation Space  
Accommodates Dry & Liquid Feeding

Recessed Entrance



Defensible, Low-Profile Entrance  
Protects Landing Board from Bad Weather  
Reduces Robbing Bees and Yellow Jackets  
Protects from Robbing Birds  
Auxiliary Rear Entrance

## NEW Deep Hive Cover



Polymetal Lid with Protective Eaves  
Screened Ventilation  
Large Internal Space for:  
Feeding, Ventilation, & Insulation

Competitive Shipping  
Saturday Store with  
Free Pickup in Oregon

Full Line of  
Beekeeping Supplies

Please visit our website  
[HiveandGarden.com](http://HiveandGarden.com)

503.737.9350

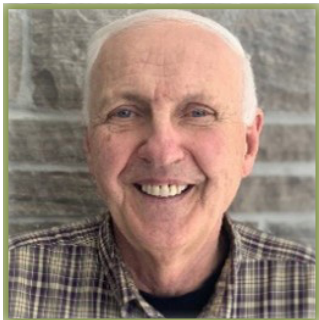

Focusing on the bee industry for the past eight years at Canada Wax, **Tony Kadai** used his extensive chemistry background to develop HIVEGUARD®, a proprietary dipping wax to address a need in the market. During this time, he has enjoyed meeting and working with many beekeepers across Canada and the US in a consultative manner. Education on the benefits of wax dipping woodenware for the beekeeping industry remains a top priority, and he is proud to be able to offer the industry a superior product that is environmentally friendly and FDA food compliant. Tony gained extensive experience during 30+ years at a multinational packaging company, followed by seven years as an independent consultant. He has a PhD in organic chemistry from McMaster University, Hamilton, and an MBA in product development, McGill University.



**Andony Melathopoulos** is associate professor in pollinator health extension in the Department of Horticulture at Oregon State University, which was the first such position in the US. He also sits on the Steering Committee of the Oregon Bee Project, which coordinates pollinator health work across state agencies, leads the Oregon Bee Atlas, and hosts a weekly podcast called *PolliNation*.



**Adrian Perez** is a live bee removal specialist and owner of Gold Coast Bee Company, based in south Florida. Adrian has been beekeeping and performing live bee removals since 2011. He currently manages several apiaries across Florida, including on the Florida Keys, where he produces varietal honeys including mangrove, palmetto, Brazilian pepper, and wildflower. In the past twelve years, he has removed bees from hundreds of different locations, ranging from irrigation boxes to multi-story buildings.



**Selena Rampolla** is the 22-year-old daughter of Faye Turke and Renato Rampolla of Lutz and Tampa, Florida. She is a graduate of the University of South Florida with a bachelor's degree in psychology and currently works for beekeeping operations in Florida. As the 2023 American Honey Queen, Selena is a national spokesperson for the American Beekeeping Federation, which represents beekeepers and honey producers throughout the US. The American Honey Queen and Princess speak and promote in venues nationwide, and Queen Selena has travelled extensively on behalf of the organization promoting the industry at fairs, festivals, and farmers' markets; providing educational programming to K–12 students; maintaining multiple social media platforms; and participating in media interviews in print, television, and radio formats.



**Ramesh Sagili**, professor in the Department of Horticulture at Oregon State University, leads the OSU Honey Bee Lab. He obtained his PhD in entomology from Texas A&M University specializing in honey bee research. His primary research focus is honey bee health, nutrition, and pollination. Ramesh initiated the creation of the Oregon Master Beekeeper Program and chaired the Oregon Governor's Task Force on Pollinator Health. His research program addresses both basic and applied questions to improve honey bee health and nutrition; hence, the majority of his research projects are collaborative efforts involving both beekeepers and growers. The OSU Honey Bee Lab is at the forefront of critical honey bee nutrition research, and their Oregon Master Beekeeper Program is among the top bee extension programs in the nation.



# ACORN™

## BEEKEEPING EQUIPMENT

**"THE NEW STANDARD OF EXCELLENCE AND QUALITY"**

**The Bee's Choice**



**NO BOWING OR WARPING**

No Ear Breakage

### Acorn One Piece Plastic Frames

- Flatter, Stiffer, Sturdier
- Re-Designed Mega Strong Ears Resist Breakage
- 9-1/8" and 6-1/4" Sizes



**FLATTER STIFFER STURDIER**

Breakaway Corners

### Plastic Snap-In Foundations

- Our Plastic Snap-in Foundations fit well in 9-1/8" and 6-1/4" wood frames
- Optional Breakaway Communication Hole



### Pre-Assembled Wooden Frames

- 9-1/8" and 6-1/4" Sizes
- Pre-Assembled With Acorn Plastic Foundation
- Standard, Heavy and Extra Heavy Waxed Available

## Features

- Well Defined Precision Molded Cell Base
- High Quality Beeswax Used
- Rigorously Field Tested
- Excellent Bee Acceptance



Deeper Precision Molded Cells

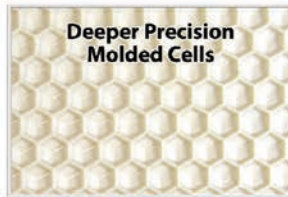

**Superbly Waxed - Standard, Heavy and Extra Heavy Waxed Available!**

info@acornbee.com  
www.acornbee.com

**Walter Hafner**

13818 Oaks Ave. Chino, Ca 91710

**CALL ANYTIME 24/7  
626-216-7217**



# AVANT® BEEHIVE MOVER

CALL OR EMAIL FOR MORE INFORMATION OR PURCHASE TODAY!

**IN STOCK NOW**



Shown Beehive Mover Attachment



**FMI**  
EQUIPMENT  
SALES • SERVICE • RENTALS

**971•533•3299**  
sales@fmiequipment.com

Financing provided by AP Equipment Financing





**Sarah Wood**, MSc, DVM, PhD, DACVP, is research chair in pollinator health, associate professor, Department of Veterinary Pathology, Western College of Veterinary Medicine (WCVN), University of Saskatchewan, Saskatoon, Saskatchewan, Canada. In 2015, Sarah co-founded the WCVN Honey Bee Health Research and Teaching Program, one of the first honey bee laboratories to be established at a veterinary school in North America. Sarah has worked as a small animal veterinarian and a diagnostic veterinary pathologist, and she is now thrilled to serve beekeepers as the first veterinary research chair in pollinator health in North America. Her research interests include infectious disease and toxicology of honey bees, and the role of pollinators in sustainable agriculture.



In the early 1960s, **Marjie Ehry** and Alan Ehry joined the Oregon State Beekeepers Association and became submerged in every function of the group. In about 1965, Marjie began helping set up the OSBA honey exhibit at the Oregon State Fair. Today, the display is the largest educational attraction at the state fair. Next, she learned the ropes of judging honey, taking classes throughout the years to increase and refine her skills. Among her many activities and varied beekeeping experiences, Marjie was the Oregon Honey Queen Program coordinator and chaperone, is a founding member of the Willamette Valley Beekeepers Association (1967), and has served as OSBA president. Her mission has been, and continues to be, sharing the story of the miraculous honey bee and encouraging beekeepers to work together.

## Oregon State Beekeepers Association

The Oregon State Beekeepers Association is a nonprofit organization dedicated to the well-being of honey bees and to the fields of beekeeping, apiculture, research, and education. The association is organized exclusively for charitable, education, and/or scientific purposes under Section 501(c)(3) of the Internal Revenue Code. Our stated purpose is to unite the beekeepers of Oregon in an effort to improve beekeeping in the state.

DECEMBER 5-7, 2023

SAFE CREDIT UNION  
CONVENTION CENTER

DOWNTOWN  
SACRAMENTO

The Almond Conference brings together growers and other industry stakeholders to serve as the **premier** gathering for networking, education and research in the almond industry. The conference promotes collaboration by fostering a sense of community among all those who are committed to the success of California's almond industry.

Don't miss out — learn more and register at [Almonds.com/Conference](https://Almonds.com/Conference)



VISIT [ALMONDS.COM/CONFERENCE](https://Almonds.com/Conference)  
TO REGISTER, AND STAY UP-TO-DATE

2023

THE ALMOND CONFERENCE

**Connecting  
the Dots**

GROWERS // HANDLERS //  
CUSTOMERS // CONSUMERS

## Riverhouse Convention Center Session & Event Locations

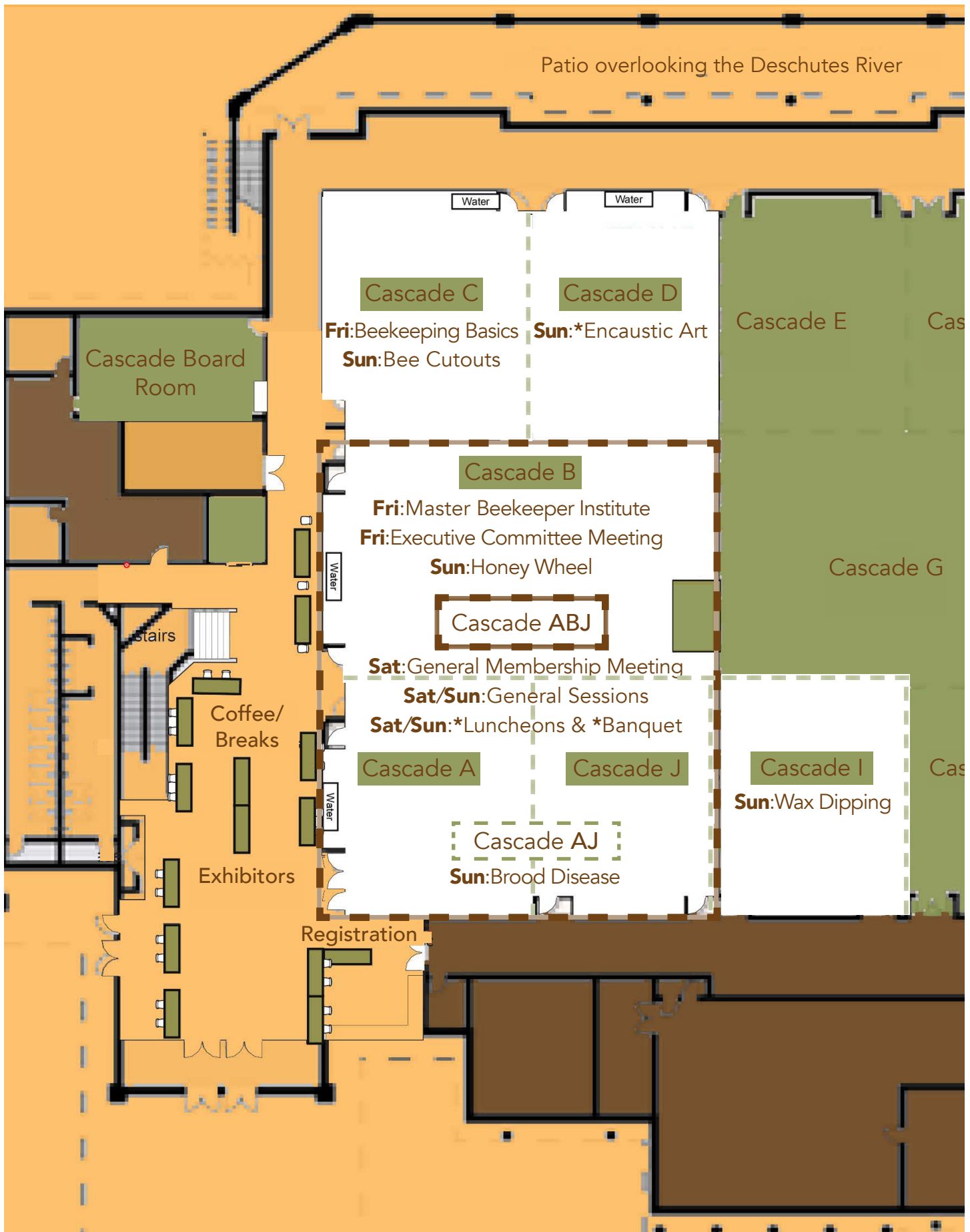



## Conference Agenda

### — Friday, October 27 —

1:00–5:30 PM **Registration, Submit Auction Items, Submit All Honey Show Entries, Exhibitor Move-In** (Lobby)

**PreConference Workshop** (Cascade C)

1:30–4:15 PM **Beekeeping Basics**

Dewey Caron, University of Delaware, Emeritus

**Oregon Master Beekeeper Institute** (Cascade B)

2:00–2:35 PM **Bees and Books: From Backyard Hobbyist to Novelist**—Eileen Garvin, Oregon Master Beekeeper/Author

2:35–3:15 PM **Spotlight on the Central Oregon Master Beekeeper Group**

3:15–4:00 PM **How to Set Up a Honey Tasting**

Amina Harris, UC Davis Honey and Pollination Center, Retired

4:30–6:00 PM **Executive Committee Meeting** (Cascade B)

7:00–9:00 PM **Evening Social** (Deschutes North & South, in Hotel)

### — Saturday, October 28 —

7:00–8:30 AM **Submit All Honey Show Entries** (Lobby)

7:00–10:00 AM **Exhibitor Move-In** (Lobby)

7:00 AM–5:00 PM **Registration, Submit Auction Items** (Lobby)

**General Session** (All in Cascade ABJ unless otherwise noted)

8:00–8:10 AM **Welcome & Announcements**

Joe Maresh & Jeremy Mitchell, OSBA

8:15–9:15 AM **Improving Honey Bee Health to Ensure Sustainable Blueberry Pollination**

Sarah Wood, University of Saskatchewan

9:20–10:00 AM **The BeeMD**

Dewey Caron, University of Delaware, Emeritus

10:00 AM–6:00 PM **Exhibitor Tradeshow Open** (Lobby)

10:00–10:30 AM **Break in Exhibitor Tradeshow** (Lobby)

10:30–11:30 AM **Interactions Among Bee Species: How Do Honey Bees Affect Other Species of Bees?**

Diana Cox-Foster, USDA ARS, Logan, Utah

11:30–12:15 PM **Donations to OSU Honey Bee Lab**

12:15–12:30 PM **Break** (Luncheon Set Up)

**\*Luncheon** (12:30–2:00 PM)

1:00–1:30 PM **The Biggest Bee Plant Network in the WORLD and Why It Matters to You**

Andony Melathopoulos, Oregon Bee Project

2:05–3:05 PM **Enhance Honey Sales Through Self-Education**

Amina Harris, UC Davis Honey and Pollination Center, Retired

3:15–3:45 PM **Oxalic Acid Vaporization Efficacy on Varroa**—Mustafa Bozkus, OSU Graduate Student

3:45–4:05 PM **Break in Exhibitor Tradeshow** (Lobby)

4:05–4:30 PM **Is It Feasible to Create a Statewide Pesticide Monitoring Network?**

Emily Carlson, OSU Graduate Student

*\*Registration with additional cost required.*

4:35–4:55 PM **Honey Bee Pollination of Day-Neutral Strawberries Grown in Tunnels**

Joussy Hidrobo Chavez, OSU Graduate Student

5:00–6:00 PM **General Membership Meeting**

6:00–7:00 PM **Social Hour** (Location TBD)

7:00 PM **Silent Auction & Online Auction End**

**\*Banquet Dinner and Benefit Auction** (7:00–10:00 PM)

7:30–8:00 PM **Project Apis m. Update**

George Hansen, Project Apis m.

8:10–8:40 PM **Promoting Honey Across the Nation: Tips and Tricks to Include in Your Promotion and a Recap of 2023 Promotions**—Selena Rampolla, American Honey Queen

### — Sunday, October 29 —

7:00–8:00 AM **Registration** (Lobby)

7:00 AM–12:30 PM **Exhibitor Tradeshow Open** (Lobby)

**General Session** (All in Cascade ABJ unless otherwise noted)

8:00–8:10 AM **Welcome & Announcements**

Joe Maresh & Jeremy Mitchell, OSBA

8:15–9:15 AM **Emergence and Control of Antimicrobial-Resistant Foulbrood Disease**

Sarah Wood, University of Saskatchewan

9:20–10:20 AM **Commercial Pollination of Fruit and Nut Crops: Synergistic Interactions Between Honey Bees and Managed Blue Orchard Bees**

Diana Cox-Foster, USDA ARS, Logan, Utah

10:20–10:50 AM **Break in Exhibitor Tradeshow, Submit Tradeshow Passport at Registration Desk** (Lobby)

**Breakout Sessions** (10:50 AM–12:15 PM)

**I. Honey Tasting and The UC Davis Honey Aroma and Flavor Wheel** (Cascade B)

Amina Harris, UC Davis Honey and Pollination Center, Retired

**II. Honey Bee Live Removals and Cutouts** (Cascade C)

Adrian Perez, Gold Coast Bee Company

**III. OSU Honey Bee Lab Brood Disease Workshop**

(Cascade AJ)—Carolyn Breece, OSU Honey Bee Lab

**IV. Essentials for Wax Dipping of Bee Hive Woodenware**

(Cascade I)—Tony Kadai, Canada Wax Company

**V. \*Encaustic Art Workshop** (Cascade D)

George Hansen, Foothills Honey Company LLC

12:15–12:30 PM **Break** (Luncheon Set Up)

12:30–3:30 PM **Exhibitor Move-Out** (Lobby)

**\*Luncheon** (12:30–2:00 PM)

1:00–1:30 PM **OSU Honey Bee Lab Services for Beekeepers and Overview of Current Research**

Ramesh Sagili, Oregon State University Honey Bee Lab

1:40–2:00 PM **Honey Auction**

2:00–2:15 PM **Break**

2:30 PM **Final Comments, Tradeshow Prizes & Adjourn**

Joe Maresh & Jeremy Mitchell, OSBA

# WESTERN BEE SUPPLIES

1965

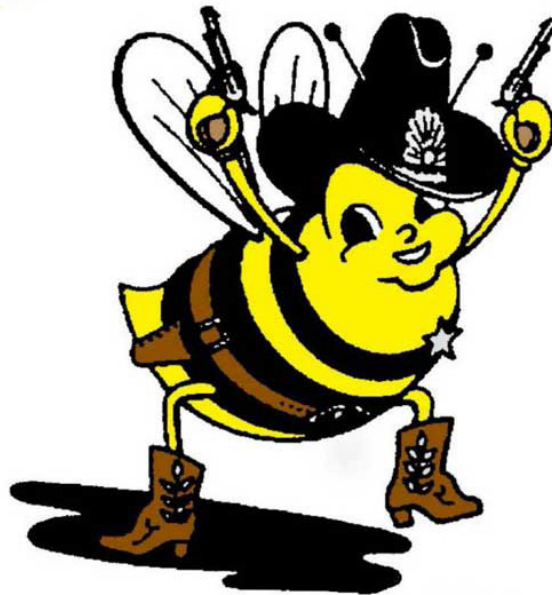

2023

## POLSON, MONTANA



**The Beekeeper's  
Carpenter**  
Home of the "Valkyrie"  
Long Hive  
*"Easier on the Bees, Easier for the  
Beekeeper!"*



A "one-and-done"  
hive from Bruce's  
hand-crafted quality!  
We're in the vendor's  
area or:

CALL VIVIEN

[www.thebeekeeperscarpenter.com](http://www.thebeekeeperscarpenter.com)  
[thebeekeeperscarpenter@outlook.com](mailto:thebeekeeperscarpenter@outlook.com)

## WiFi Hive Scale

For the busy beekeeper

*Lowest cost solution*



You can't manage  
what you don't  
measure

**Steady stream of data will help  
you know Almost as much as the  
Queen Knows about her hive!**

Monitor hive data Anywhere on  
PC, Phone, or Tablet

[www.wifihivescale.com](http://www.wifihivescale.com)

[info@wifihivescale.com](mailto:info@wifihivescale.com)



## Conference Abstracts

Conference Silver Sponsor: Richards Packaging

— Friday, October 27 —

Registration, Honey Show/Auction Entries & Exhibitor Move-In (1:00–5:30 PM | Lobby)

### PreConference Workshop (Cascade C)

1:30–4:15 PM—**Beekeeping Basics**

Dewey Caron, University of Delaware, Emeritus

We will cover the four seasons, beginning with the coming winter, emphasizing colony biology and management for the annual population cycle of both honey bees and bee mites. Management options for buildup and keeping colonies together, if surplus honey is an objective, will be featured. A season-long plan to flatten the mite growth curve and keep eventual mite population at lower level will be outlined. And we will look at we don't know that we need to know to succeed in bee colony care.

### Oregon Master Beekeeper Program Institute (Cascade B)

2:00–2:35 PM **Bees and Books: From Backyard Hobbyist to Novelist**

Eileen Garvin, Oregon Master Beekeeper/Author

Little did I know the day I received my first package of bees that beekeeping would change my life in unimaginable ways. In this talk, I'll describe how my hobby of backyard beekeeping led to writing a novel about beekeepers that became a national bestseller—*The Music of Bees*. Over the past two years, I've spoken to hundreds of audiences about *The Music of Bees*. I'll discuss how readers' curiosity about beekeeping has been an unexpected education of its own.

2:35–3:15 PM **Spotlight on the Central Oregon Master Beekeeper Group**

3:15–4:00 PM **How to Set Up a Honey Tasting**

Amina Harris, UC Davis Honey and Pollination Center, Retired/Owner of Z Specialty, The HIVE

The more you know and can share with your customer, the more honey you will sell and the more honey will be sold. This session aims to teach you a bit about tasting honey and sharing the experience by setting up a honey tasting event. There is more to honey than what meets the eye. Learn how to describe the experience of tasting honey with the use of the UC Davis Honey Aroma and Flavor Wheel, which gives a huge lexicon to the tastes and aromas we find when tasting honey.

4:30–6:00 PM **OSBA Executive Committee Meeting** (Cascade B)

Evening Social (7:00–9:00 PM | Deschutes North & South, inside Hotel)  
with John Grant and the Western Revue

Sponsored by Wraith Scarlett & Randolph Insurance Services Inc

\*Conference Luncheons, Banquet, and Encaustic Art Workshop require registration with additional cost.



## Help launch the Oregon bee license - fund bee research

Success! All 3,000 license plate vouchers were sold in record time this year! If you didn't get a voucher, not to worry, everyone can purchase the plate through Oregon DMV beginning November

1. Two pollinator plates will also be available by auction and raffle at this year's Conference!

[www.oregonbeeplate.org](http://www.oregonbeeplate.org)

## Beeline Apiaries & Woodenware

See us for all your beekeeping supplies!

Woodenware      Bee Health Products  
Foundation      Suits and Jackets  
Tools              Books  
Oxalic Acid Vaporizers

**Bee Packages and Nucs available in Spring**

**PH:** 360-280-5274

**Email:** [beelineofwa@norcell.us](mailto:beelineofwa@norcell.us)

### Store Hours:

Open Monday – Friday 8 AM to 5 PM

Saturday -- By Appointment

Sunday – Closed

Sept. – Jan

Tues. – Thurs. 8 AM to 5 PM

Store Address: 19019 Moon Rd SW Rochester, WA 98579



STATE FARM®  
INSURANCE AGENT



## Kent Irving

2395 12th Street SE

Salem, OR 97302

503-378-1509

[kent.irving.b729@statefarm.com](mailto:kent.irving.b729@statefarm.com)



## — Saturday, October 28 —

### Registration, Honey Show/Auction Entries & Exhibitor Move-In (Lobby)

7:00–8:30 AM **Submit All Honey Show Entries**

7:00–10:00 AM **Exhibitor Move-In**

7:00 AM–5:00 PM **Registration, Submit Auction Items**

### General Session (All events in Cascade ABJ, unless otherwise noted)

8:00–8:10 AM **Welcome & Announcements**

Joe Maresh & Jeremy Mitchell, OSBA

8:15–9:15 AM **Improving Honey Bee Health to Ensure Sustainable Blueberry Pollination**

Sarah Wood, University of Saskatchewan

We will discuss integrated pest management strategies to improve colony health before, during, and after blueberry pollination to enhance the profitability of both the beekeeping and the blueberry industries in North America.

9:20–10:00 AM **The BeeMD**

Dewey Caron, University of Delaware, Emeritus

The BeeMD is a web-based (app eventually) diagnostic application for use in the field to diagnose honey bee health problems. I have spent the last year revising the Pollinator Protection (P2) BeeMD website and am in process of moving it to a USDA, APHIS, Information and Technology server. The new server has many user-friendly features to help find answers for what you might encounter in the bee hive. We will look at this resource and maybe even answer a question or two you have about your bees as we begin a new bee year.

10:00 AM–6:00 PM **Exhibitor Tradeshow Open** (Lobby)

### Break in Exhibitor Tradeshow (10:00–10:30 AM | Lobby)

**Sponsored by The Beetanical Apiary**

10:30–11:30 AM **Interactions Among Bee Species: How Do Honey Bees Affect Other Species of Bees?**

Diana Cox-Foster, USDA Agricultural Research Service, Logan, Utah

Over 4,000 different species of bees are found in the United States. All these bees share the need for pollen and nectar for reproduction. Unfortunately, one of the major causes of poor bee health is the lack of floral resources or “bee pasture,” which has been exacerbated by high temperatures and drought in the western states. Concerns about the impacts of honey bee apiaries or colonies on other bee species are causing some to restrict the placement of honey bees. In this talk, I will present data from our three-year study that asked how honey bees interact with and affect other species of bees. We did experiments both in cages and in the field to answer this question. Experiments in cages generated competition by restricting the bees over a set amount of floral resources. In this restrictive environment that lacked unlimited floral resources, we did find that reproduction and colony growth was negatively impacted for honey bees, bumble bees, and solitary bees equally. We also examined the interactions of bees on flowers and did not find any “bullies” or aggressors among the different types of bees. We then extended our research to a natural wild setting and examined the impact of a honey bee apiary on sentinel bumble bee colonies and sentinel solitary bees, as well as the endemic native bees. We examined reproduction, floral interactions, and disease/health of the bees. We found no evidence for competition by the honey bees with the other species, but our research does help reveal the importance of defining the carrying capacity of a location (how much food and how many mouths to feed). The list of factors and consumers impacting carrying capacity is expanded when other land uses and weather are considered.

11:30–12:15 PM **Donations to Oregon State University Honey Bee Lab**



## **Farm Crop & Seed Pollination Services**

- **Oregon, California, Washington**
- **Competitive Prices, Excellent Bees**

**CALL OR TEXT**

**CHAD: (541) 861-0983**

**KOBY: (509) 540-0673**

**Email: [wwwhc@yahoo.com](mailto:wwwhc@yahoo.com)**

**Walla Walla Valley Honey Company • Walla Walla, Washington**



## Break (12:15–12:30 PM | Luncheon Set Up)

### \*Luncheon (12:30–2:00 PM)

#### 1:00–1:30 PM **The Biggest Bee Plant Network in the WORLD and Why It Matters to You**

Andony Melathopoulos, Oregon Bee Project

Your very own Oregon Bee Atlas has been chugging along recording weird bees across Oregon. In addition to turning up the darnedest bees and countless new state records, our Master Melittologist volunteers have been diligently documenting which plants bees are using. This has resulted in the most comprehensive network of bee-plant interactions. The talk will reveal some of the most important bee plants of the state and discuss what it means for: (a) initiatives to get farmers to plant more bee plants, and (b) ensuring we have sound policy for maximizing resources for honey bees AND our 700+ wild species.

#### 2:05–3:05 PM **Enhance Honey Sales Through Self-Education**

Amina Harris, UC Davis Honey and Pollination Center, Retired/Owner of Z Specialty, The HIVE

The more you know and can share with your customer, the more honey you will sell and the more honey will be sold. This session aims to teach you a bit about promoting honey, its use in a variety of applications, and that the bees and their magical handiwork are what great labeling is all about. We will discuss what MUST be on a honey label and what we wish we could put on that label, but can't! We will talk about what honey is in the jar and what you should call it. And finally, we will discuss how to promote your honey encouraging consumers to use it in a multitude of ways from cooking to healing.

#### 3:15–3:45 PM **Oxalic Acid Vaporization Efficacy on Varroa**

Mustafa Bozkus, Graduate Student, Oregon State University

We evaluated three different doses of oxalic acid (1g, 2g, and 4g) and a control group (no OA) per brood chamber in 2021. In 2022, we evaluated two different doses of oxalic acid (3 g and 4 g) and a control group per brood chamber to assess the efficacy and safety of OA. In both 2021 and 2022, the 4 g treatment had higher Varroa mortality than the other groups and did not have any significant effects on the adult bee population and brood rearing. To better understand the effects of OA on developing larvae, we monitored larval mortality after the 4 g and 3 g OA applications in 2022. Our results show that the 4 g OA dose resulted in higher larval mortality compared to 3 g OA and control (no OA) in our 2022 experiment. Based on our results, it appears that 3 g OA treatment may be the ideal dose, as it provides optimal Varroa control and is relatively safe to larvae.

## Break in Exhibitor Tradeshow (3:45–4:05 PM | Lobby)

Sponsored by Nature's Kick Corporation

#### 4:05–4:30 PM **Is It Feasible to Create a Statewide Pesticide Monitoring Network?**

Emily Carlson, Graduate Student, Oregon State University

Pesticide exposure is of great concern to beekeepers, but understanding what pesticide exposure looks like in a landscape is a challenge. Pollen collected from honey bee colonies is one common way of monitoring how pesticides load in the environment and within a honey bee hive. However, it is unclear if this style of monitoring method could detect realistic changes in pesticide exposure to bees. Beekeepers and policy-makers are interested in designing a way to monitor pesticides in bee hives. Could trapped pollen be used to track changes in pesticide exposure over time? How many sites would we need to include to be effective? In this presentation, we will discuss the results from 70 sites where pollen trapping occurred over two years and the estimated costs of such a monitoring program.

#### 4:35–4:55 PM **Honey Bee Pollination of Day-Neutral Strawberries Grown in Tunnels**

Joussy Hidrobo Chavez, Graduate Student, Oregon State University

The use of tunnel systems has become more popular in northern regions because they can raise temperatures and help extend the growing season for crops. However, how the presence of plastic covers can affect bee pollination is unsure. In this presentation, we will share the outcome of an experiment conducted to evaluate 'Albion' and 'Seascape' strawberry cultivars using four tunnel treatments and one hive for honey bee pollination. Some flowers were excluded from pollination to simulate the protection layer. The fruit was compared to the unbagged treatment.

# Heitkams'

HONEY BEES INC



## Fresh Queens

**We Are Selecting for Hygienic Behavior**

Italian — Carniolan — Caucasian  
Spring — Summer — Fall  
Quality Queens — Dependable Service

Call or Write (530) 865-9562  
4700 First Ave — Orland CA 95963  
[queens@heitkamshoneybees.com](mailto:queens@heitkamshoneybees.com)

### FULL LINE OF BEEKEEPING SUPPLIES

- Bee Suits & Jackets
- Bee Nutrition
- Mite Treatments
- Assembled/Unassembled Woodenware
- Feeders
- Knowledgeable Staff

**MANN LAKE**  
AUTHORIZED DEALER



FLYING  
**BEE**  
RANCH

Open Year-Round  
Tue - Sat 9a-5p  
5180 Lardon Rd. N.E.  
Salem, OR 97305

[www.FlyingBeeRanch.net](http://www.FlyingBeeRanch.net)  
[Info@FlyingBeeRanch.net](mailto:Info@FlyingBeeRanch.net)  
(503) 399-8409

HONEY TASTING ROOM • OREGON'S LARGEST SELECTION OF VARIETAL HONEYS  
BEEKEEPING CLASSES AND NUCS AVAILABLE IN THE SPRING



5:00–6:00 PM **General Membership Meeting**

**Social Hour (6:00–7:00 PM | Location TBD)**

7:00 PM **Silent Auction & Online Auction End**

**\*Banquet Dinner & Benefit Auction (7:00–10:00 PM)**

7:30–8:00 PM **Project Apis m. Update**

George Hansen, Project Apis m.

Project Apis m. is a nonprofit organization that funds research for the honey bee industry. It is the largest nongovernment source of funds for bee research in North America. The organization strives to support projects that will have practical outcomes for beekeepers.

8:10–8:40 PM **Promoting Honey Across the Nation: Tips and Tricks to Include in Your Promotion and a Recap of 2023 Promotions**

Selena Rampolla, American Honey Queen

2023 American Honey Queen Selena Rampolla will transport you throughout the United States as she highlights promotional successes throughout her year of service to the nation's beekeeping industry serving as a spokesperson and promoter of honey and the beekeeping industry. She will provide insight on her travels throughout the country, including the unique ways the industry has been highlighted at venues throughout the nation, providing you with tips and tricks to take back to your hometown promotional events. Selena will highlight her experience working as a national spokesperson for the industry and provide insights on participating in this unique program as a promotional sponsor to spokesperson.

## — Sunday, October 29 —

**General Registration & Tradeshow (Lobby)**

7:00–8:00 AM **Registration**

7:00 AM–12:30 PM **Exhibitor Tradeshow Open**

**General Session (All events in Cascade ABJ, unless otherwise noted)**

8:00–8:10 AM **Welcome & Announcements**

Joe Maresh & Jeremy Mitchell, OSBA

8:15–9:15 AM **Emergence and Control of Antimicrobial-Resistant Foulbrood Disease**

Sarah Wood, University of Saskatchewan

We will discuss evidence-based use of antibiotics in the North American beekeeping industry to minimize the spread of antimicrobial-resistant strains of European and American foulbrood disease.

9:20–10:20 AM **Commercial Pollination of Fruit and Nut Crops: Synergistic Interactions Between Honey Bees and Managed Blue Orchard Bees**

Diana Cox-Foster, USDA Agricultural Research Service, Logan, Utah

Several fruit and nut crops require pollination by bees for fruit and nut set. The demand for honey bee colonies is critical for some of these crops, since growers are often required to have a set number of hives per acre. Weather can also affect pollination by honey bees if the temperatures are too cold or there is too much rain. In this talk, I will describe our research that has demonstrated how honey bees and the blue orchard bees can work together in an orchard to give synergistically higher fruit set. I will describe how the two bees can be used together. I will discuss the life cycle of the blue orchard bee, how it can be managed, and the opportunity for a bee keeper to potentially manage both species. I will also describe our research that examines the impacts of pesticides on both species and their health. The role of the pesticides at sublethal levels or chronic exposures on bee health will be discussed.

# FOOTHILLS HONEY COMPANY

Family owned & operated multi-generational commercial apiary less than an hour from Portland

30576 Oswalt Road | Colton OR 97017 | (503) 824-2265

## Nucleus Hives for Sale Every Spring

- 5-frame nucs, pickups starting in early April, first ordered-first served
- Mated queen out & laying
- Competitive pricing with group discounts for clubs & commercial
- Available in portable cardboard boxes closed for transport
- We stand by our product

## Honey & Beeswax for Sale Year-Round

- Raw, local honey
- Drum barrels, buckets or smaller quantities available by appointment
- Clover, wildflower, blackberry & more
- Great options for brewing, gifts, or just stocking up
- Bulk yellow capping wax available in the fall

*Thanks to all our 2023 customers, and we hope to see you again in 2024!*



## AP23<sup>®</sup>

Artificial Pollen 23

## WINTER PATTIES

Dadant's winter patties are a multifunctional patty, high in carbohydrates and 3% protein to help keep your colonies strong through the winter months.

Contains: sugar, AP23 and Honey-B-Healthy

- Can be used in winter & early spring in place of candy boards
- Readily accepted by the bees
- Convenient for all beekeepers
- Currently available at your nearest Dadant branch location

QUANTITY  
PRICING  
AVAILABLE



WWW.DADANT.COM



**Breakout Sessions (10:50 AM–12:15 PM)**

**I. Honey Tasting & The UC Davis Honey Aroma and Flavor Wheel** (Cascade B)

Amina Harris, UC Davis Honey and Pollination Center, Retired/Owner of Z Specialty, The HIVE

There is more to honey than what meets the eye. Learn how to describe your honey-tasting experience using the UC Davis Honey Aroma and Flavor Wheel, which gives a huge lexicon to the tastes and aromas we find when tasting honey.

**II. Honey Bee Live Removals and Cutouts** (Cascade C)

Adrian Perez, Gold Coast Bee Company

Have you ever considered performing live honey bee removals, cutouts, or relocations? Come learn how to size up a honey bee removal job, the rules and regulations in Oregon, what tools are needed, how to perform removals, and whether or not to charge for your services.

**III. OSU Honey Bee Lab Brood Disease Workshop** (Cascade AJ)

Carolyn Breece, Oregon State University Honey Bee Lab

A workshop about common honey bee brood diseases. Learn about disease identification, diagnostic tools and procedures, beekeeper resources, and more!

**IV. Essentials for Wax Dipping of Bee Hive Woodenware** (Cascade I)

Tony Kadaï, Canada Wax Company

Explore the history of hot wax dipping from 2001 to the present in the US and Canadian markets. A science-based approach to traditional materials used, properties of waxes, including the ideal properties of a dipping wax, and the advantages of using an appropriate paraffin and microcrystalline blend will be discussed. The dipping process and equipment will also be reviewed. Finally, a cost analysis will be provided to illustrate the costs associated with dipping woodenware.

**V. \*Encaustic Art Workshop** (Cascade D)

George Hansen, Foothills Honey Company LLC

Encaustic is an ancient art medium using beeswax. The wax is pigmented and applied hot while it is liquid. Because the layers of wax are fused together with heat, encaustic is often referred to as *painting with fire*. The workshop will give attendees a chance to actually paint and create, while a variety of techniques will be demonstrated. Materials will be provided. Children must be accompanied by an adult.

**Break (12:15–12:30 PM | Luncheon Set Up)**

12:30–3:30 PM **Exhibitor Move-Out** (Lobby)

**\*Luncheon (12:30–2:00 PM)**

**1:00–1:30 PM OSU Honey Bee Lab Services for Beekeepers and Overview of Current Research**

Ramesh Sagili, Oregon State University Honey Bee Lab

The Oregon State University Honey Bee Lab strives to provide valuable services to Oregon beekeepers to improve honey bee health. This presentation will provide information pertaining to services provided by the OSU Honey Bee Lab for Oregon beekeepers. Further, an overview of current research projects being conducted by the OSU Honey Bee Lab will also be provided.

**1:40–2:00 PM Honey Auction**

**Break (2:00–2:15 PM)**

2:30 PM **Final Comments, Tradeshow Prizes & Adjourn**

Joe Maresh & Jeremy Mitchell, OSBA



Oregon State Beekeepers Association  
4207 SE Woodstock Blvd Ste 517  
Portland OR 97206  
[orsba.org](http://orsba.org)

## Thank You, Everyone!

Thank you to all attending in person and participating online, all presenting, all exhibiting and advertising and sponsoring, all donating to and participating in the online auction and the on-site silent & benefit auctions, all working behind the scenes, and so many more!

